

SHOCK ABSORBER INSPECTION

All Models Equipped with Hydraulic Shock

NOTE: Hydraulic shocks are black painted.

Secure the shock body end in a vise with its rod upward.

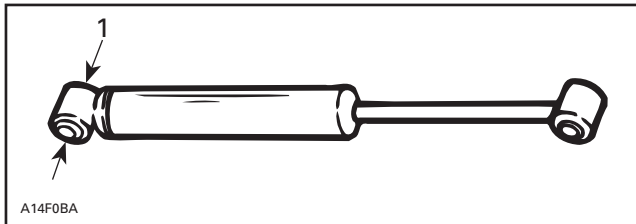

1. Clamp

CAUTION: Do not clamp directly on shock body.

Examine each shock for leaks. Extend and compress the piston several times over its entire stroke. Check that it moves smoothly and with uniform resistance with its rod upward.

Pay attention to the following conditions that will denote a defective shock:

- A skip or a hang back when reversing stroke at mid travel.
- Seizing or binding condition except at extreme end of either stroke.
- Oil leakage.
- A gurgling noise, after completing one full compression and extension stroke.

Renew if any faults are present.

All Models Equipped with Gas Pressurized Shock

NOTE: Gas pressurized shocks are light gray or purple painted, or bare aluminum.

Gas shock can be inspected as follows:

Because of gas pressure, strong resistance is felt when compressing shock. When released, the shock will extend unassisted. Renew as required.

If suspecting an internal gas leak between oil chamber and gas chamber, check shock as follows:

Install shock in a vise clamping on its bottom eyelet with its rod upward.

Let it stand for 5 minutes.

Completely push down the shock rod then release. Rod must come out at a steady speed. If speed suddenly increases particularly at end of extension, replace shock.

If suspecting a frozen gas shock proceed as follows: Place shock in a freezer (temperature below 0°C (32°F)) for 4 hours.

Push down on rod and note its resistance, compare to a new shock. If shock is frozen it will be much more difficult to compress than for the new one.

INSTALLATION

Install assembled suspension into track with front portion first.

Insert rear portion of suspension into track.

Bolt front arm, rear arm then center top idler wheel axle.

Adjust track tension.

RIDE ADJUSTMENT

Refer to *Operator's Guide*.

LUBRICATION

Lubricate front and rear arms at grease fittings using synthetic grease (P/N 413 711 500).

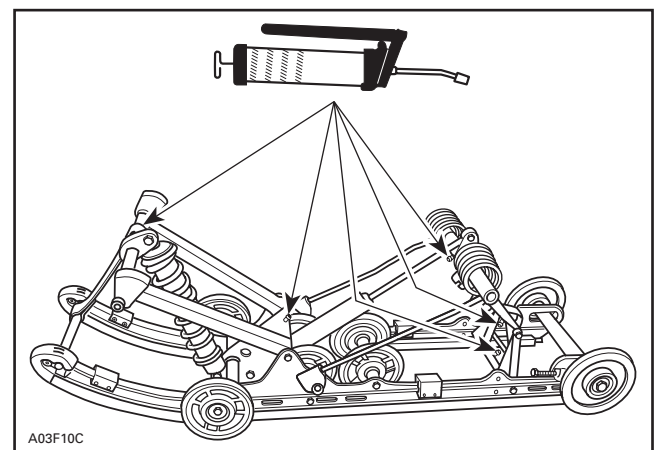

SC-10 SPORT, MOUNTAIN AND TOURING: 5 GREASE FITTINGS